

60050 S-Beam, Stainless Steel, IP67

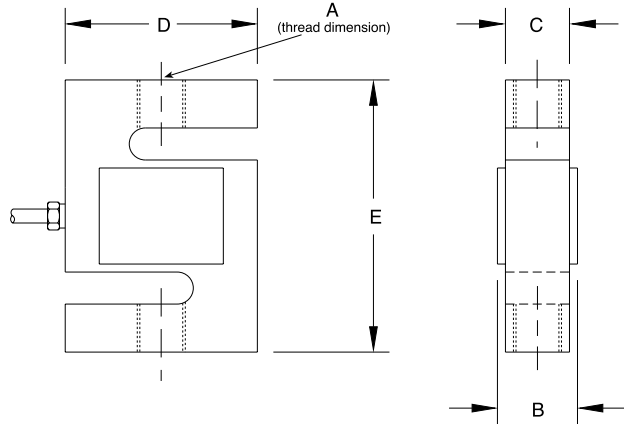

Picture is a representation of actual product



RATED CAPACITY

lb/inches
 250
 500-1500
 2000-3000
 5000
 10,000
 15,000
 20,000

	A	B	C	D	E
250	3/8-24 UNF-2B	.75	.50	2.00	3.00
500-1500	1/2-20 UNF-2B	1.00	.75	2.00	3.00
2000-3000	1/2-20 UNF-2B	1.25	1.00	2.00	3.00
5000	3/4-16 UNF-2B	1.25	1.00	3.00	4.25
10,000	3/4-16 UNF-2B	1.25	1.00	3.50	4.75
15,000	1-14 UNS-2B	1.50	1.25	4.00	5.50
20,000	1 1/4-12 UNF-2B	2.00	1.94	5.00	7.00

kg/mm

113.4
 226.8-680.4
 907.2-1360.8
 2268.0
 4535.9
 6803.9
 9071.9

113.4	3/8-24 UNF-2B	19.1	12.7	50.8	76.2
226.8-680.4	1/2-20 UNF-2B	25.4	19.1	50.8	76.2
907.2-1360.8	1/2-20 UNF-2B	31.8	25.4	50.8	76.2
2268.0	3/4-16 UNF-2B	31.8	25.4	76.2	108.0
4535.9	3/4-16 UNF-2B	31.8	25.4	88.9	120.7
6803.9	1-14 UNS-2B	38.1	31.8	101.6	139.7
9071.9	1 1/4-12 UNF-2B	50.8	49.3	127.0	177.8

SPECIFICATIONS:

Full Scale Output: 3.0 mV/V
Bridge Resistance: 350 ohms, nominal
Material/Finish: Stainless steel
Temperature: Compensated range
 0°F to 150°F/-18°C to 65°C
Manufacturer:
Model Number: 60050
Safe Overload: 150% Full scale
Rated Excitation: 10V DC (15V maximum)
Nonlinearity: 0.03% Full scale

Hysteresis: 0.02% Full scale
Insulation Resistance: 5000 megohms
Seal Type: Environmentally sealed, IP67
Cable Length: 20'/6.1 m
Cable Color Code: Red + Excitation
 Black..... - Excitation
 Green..... + Signal
 White - Signal
Warranty: 1-year limited warranty

60050 ORDER INFORMATION

Load Rating	Part #	Price
250 lb (113.4 kg)	17077	\$325.00
500 lb (226.8 kg)	17078	\$325.00
750 lb (340.2 kg)	17079	\$325.00
1000 lb (453.6 kg)	17080	\$325.00
1500 lb (680.4 kg)	17081	\$325.00
2000 lb (907.2 kg)	17082	\$365.00
2500 lb (1134.0 kg)	17083	\$365.00
3000 lb (1360.8 kg)	17084	\$365.00
5000 lb (2268.0 kg)	17085	\$550.00
10,000 lb (4535.9 kg)	17086	\$550.00
15,000 lb (6803.9 kg)	17087	\$650.00
20,000 lb (9071.9 kg)	17088	\$975.00

INTERCHANGEABLE PRODUCTS

Manufacturer	Model
Vishay Celtron	(see page 184) STC-SS

WEIGH MODULE AVAILABLE

Model	Page #
ITCM Isolated Tension Cell Mount	357