

# 9363 UNIVERSAL LOAD CELL



## DESCRIPTION:

The 9363 is a true multi-purpose stainless steel S-type load cell which can be used either in tension or compression.

This product is suitable for a wide range of hybrid scales, overhead track scales, belt scales and process weighing applications.

Reliable sealing is ensured by the proprietary TRANSEAL potting compound and additional mechanical protection of the strain gauge area.

This product meets the stringent Weights and Measures requirements throughout Europe.

## FEATURES:

- Stainless steel construction
- Certified to OIML R60, **3000d**
- Suitable for compression and tension applications
- Trimmed output as standard
- **CAPACITIES: 50 → 10000 kg**  
(100 → 20 K lbs also available)

# 9363: SPECIFICATIONS:

Standard Capacities (=E <sub>max</sub> )	kg	50 <sup>3</sup> , 100 <sup>3</sup> , 250, 500, 1000, 2500, 5000, 7500, 10000 <sup>2</sup>			
Standard Capacities (=E <sub>max</sub> )	lbs	100 <sup>3</sup> , 200 <sup>3</sup> , 300, 500, 750, 1K, 1.5K, 2K, 3K, 5K, 10K, 15K, 20K <sup>2</sup>			
Accuracy Class According to OIML R-60			C1	C2	C3
Max. Number of Verification Intervals (n <sub>ic</sub> )			1000	2000	3000
Minimum Verification Interval (v <sub>min</sub> )			E <sub>max</sub> /4500	E <sub>max</sub> /6000	E <sub>max</sub> /9000
Minimum Utilisation			25	33	33
Accuracy According to Type Designation		CC	C1	C2	C3
Combined Error	%S	≤ ± 0.0500	≤ ± 0.0300	≤ ± 0.0230	≤ ± 0.0200
Non-Repeatability	%S	≤ ± 0.0200	≤ ± 0.0200	≤ ± 0.0100	≤ ± 0.0100
Minimum Dead Load Output Return <sup>1</sup>	%S	≤ ± 0.0500	≤ ± 0.0500	≤ ± 0.0250	≤ ± 0.0167
Creep Error (30 Minutes) <sup>1</sup>	%S	≤ ± 0.0600	≤ ± 0.0490	≤ ± 0.0245	≤ ± 0.0245
Creep Error (20-30 Minutes) <sup>1</sup>	%S	≤ ± 0.0200	≤ ± 0.0105	≤ ± 0.0053	≤ ± 0.0053
Temp. Effect on Min. Dead Load Output	%S/5 °C	≤ ± 0.0250	≤ ± 0.0140	≤ ± 0.0112	≤ ± 0.0070
Temp. Effect on Sensitivity	%S/5 °C	≤ ± 0.0250	≤ ± 0.0085	≤ ± 0.0060	≤ ± 0.0050
Minimum Dead Load	%E <sub>max</sub>	0			
Maximum Safe Over Load	%E <sub>max</sub>	150			
Ultimate Over Load	%E <sub>max</sub>	250			
Maximum Safe Side Load	%E <sub>max</sub>	100			
Excitation Voltage	V	5...12			
Maximum Excitation Voltage	V	15			
Rated Output (=S)	mV/V	3.0 (± 0.0075)			
Zero Balance	%S	≤ ± 1.0			
Input resistance	Ω	430 ± 60			
Output Resistance	Ω	350 ± 3.5			
Insulation Resistance	MΩ	≥ 5000			
Compensated Temperature Range	°C	-10...+40			
Operating Temperature Range	°C	-40...+80			
Storage Temperature Range	°C	-40...+90			
Element Material (DIN)		Stainless Steel 1.4542			
Sealing (DIN 40.050 / EN 60.529)		IP65			

- 1 Applies for the temperature range -10 to +40 °C  
 2 CC accuracy only  
 3 Non-Humidity load cell (OIML R60, 1991 4.6.7 not applicable)

For same capacities: non-approved model 363 available. Further information on request.

Correct mounting of the load cells is essential to ensure optimum performance. For multiple load cell applications, trimmed versions of the 9363 type load cell enable accurate parallel connection. Further information is available on request.

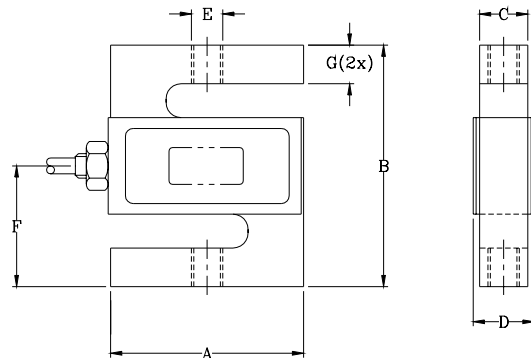

## REVERE TRANSDUCERS EUROPE B.V.

Ramshoorn 7  
 Postbus 6909, 4802 HX Breda  
 The Netherlands  
 Tel: (+31) 76-5480700  
 Fax: (+31) 76-5412854  
 E-mail: info@revere.nl

## REVERE TRANSDUCERS INC.

14192 Franklin Ave  
 Tustin, CA 92780-7016  
 U.S.A.  
 Tel: (+1) 714.731.1234  
 Fax: (+1) 714.731.2019  
 E-mail: info@reveretransducers.com

E <sub>max</sub> Kg	50,100	250,500	1000	2500	5000	7500	10000
E <sub>max</sub> Lbs	100,200,300	500-1.5K	2K, 2.5K	3K*, 5K	10K	15K	20K
A	50.8	50.8	50.8	76.2	74.7	87.4	112.8
B	61.0	61.0	61.0	99.1	99.1	139.7	177.8
C	11.7	18.0	24.4	24.4	30.7	37.1	42.9
D max.	16.5	22.9	29.2	29.2	35.6	41.4	47.8
E (kg)	M8x1.25-6H	M12x1.75-6H		M20x1.5-6H	M24x2-6H		M30x2-6H
E (Lbs)	<sup>1</sup> / <sub>4</sub> -28 UNF-2B	<sup>1</sup> / <sub>2</sub> -20 UNF-2B		<sup>3</sup> / <sub>4</sub> -16 UNF-2B	1-14 UNF-2B		<sup>1</sup> / <sub>4</sub> -12 UNF-2B
F	30.5	30.5	30.5	49.5	49.3	69.9	88.9
G	8.9	8.9	8.9	14.0	15.7	22.4	31.8

### REGIONAL OFFICE UK

The Business Centre  
 Edward Street, Redditch  
 Worcs B97 6HA, UK  
 Tel: (+44) 1527-65888  
 Fax: (+44) 1527-64888  
 E-mail: alittlejohn@revere.nl

### Cable specifications:

Cable length 6m  
 Excitation + Red  
 Excitation - Black  
 Output + Green  
 Output - White  
 Shield Orange

\* Note: 3 Klbs version has <sup>1</sup>/<sub>2</sub>-20 UNF-2B thread

### Attention:

All dimensions: mm.  
 All dimension tolerances according to ISO 2768m, unless otherwise specified.

Cable screen is not connected to load cell body. Performance may be affected if load cell cables are shortened.

All specifications subject to change without notice

2/3/66/04 E